



PROJECT		REF		REV	ITEM CODE	
LOCATION		DATE			PAGE	

SANITARY WARE SPECIFICATION SHEET

Item Descriptions	GROHE (Germany) "Grohtherm SmartControl" thermostat shower mixer with mixing device and adjustable temperature limiter with 2 valves and integrated shower holder ; "F-Series" chrome plated shower head with shower arm and hand shower ; Nominal flow rate 9 L/min & 9.7L/min in WELS Grade 1 and Grade2; Registration No. SB 17-0030 & SB 17-0002
Model	27285000 + 27488000 (Shower head & arm) 29125000 (Thermostat mixer) 35600000 (Mounting box) 27699000 (Hand Shower) 28364000 (Flexible Hose)
Material	Chrome Plated
Manufacturer	GROHE Limited
Supplier	Acme Sanitary Ware Co. Ltd Mr. Eric Wong/ Mr. Don Yuen
Contact Tel/Fax	(852) 2388-7171 / (852) 2710-8012
E-mail	acme@acmesanitary.com.hk
Website	www.acmesanitary.com.hk

Illustration/ Drawing

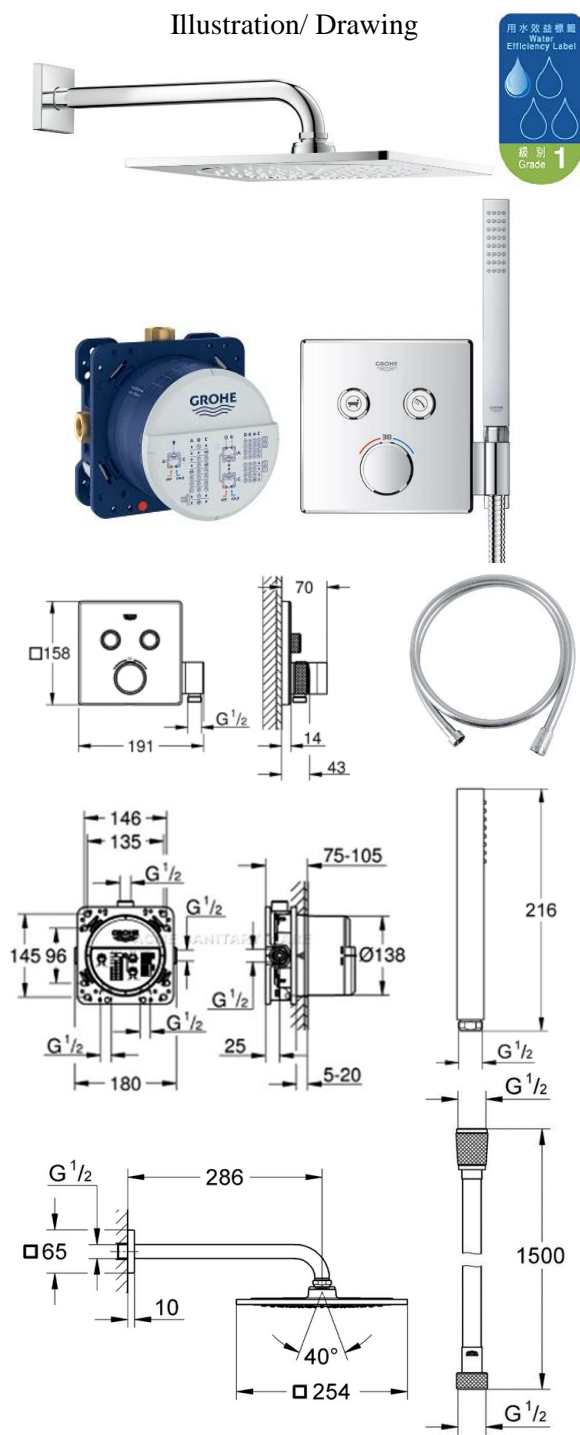

Shower head

Dynamic flow pressure (kPa)	50	150	250	350	500
Flow rate (l / min)	7.00	10.00	9.50	9.70	9.70

Hand Shower

Dynamic flow pressure (kPa)	50	150	250	350	500
Flow rate (l / min)	5.30	8.70	9.20	9.20	9.10

Note:

* All information of the above is for the reference only. No prior notice is made if any changes.



Acme Sanitary Ware Co. Ltd.

1/F, Acme Building, 22-28 Nanking Street, Kowloon, Hong Kong
Tel: 2388 7171 Fax: 2710 8012
Email: acme@acmesanitary.com.hk
Website: www.acmesanitary.com.hk



PROJECT		REF		REV	ITEM CODE	
LOCATION		DATE			PAGE	

SANITARY WARE SPECIFICATION SHEET

Grotherm SmartControl

Thermostat for concealed installation with 2 valves and integrated shower holder set for final installation for GROHE Rapido SmartBox 35 600 000 metal wall escutcheon with GROHE QuickFix (covered escutcheon and shaft sealing, covered fixing), retroactively 6° adjustable

GROHE StarLight chrome finish

GROHE SmartControl push for ON-OFF, turn for volume adjustment from EcoJoy to full flow exchangeable symbols

GROHE TurboStat compact cartridge with wax thermoelement

GROHE SafeStop safety button at 38°C (calibration required)

GROHE SafeStop Plus optional temperature limiter at 43°C included built-in non return valve and dirt strainers multiple outlets can be run simultaneously integrated shower union with shower outlet 1/2" without roughing-in-set flow performance:

outlet P = 24 l/min

GROHE Rapido SmartBox

Universal rough-in box, 1/2" 3 outlets 1/2"

2 inlets below, 1/2" installation depth 75-105 mm connection unit in DR brass pre-mounted flushing plug stable build-in box and protective cover fixing options for solid walls and dry cladding gasket without set for final installation



Illustration/ Drawing



Euphoria Cube Stick

Hand shower 1 spray

Normal spray

GROHE EcoJoy 9.5 l/min flow limiter

GROHE DreamSpray perfect spray pattern

GROHE StarLight chrome finish

SpeedClean anti-limescale system

Inner WaterGuide for a longer life

Universal Mounting System. Fits all

standard shower hoses

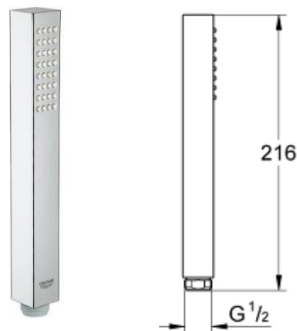

Product description

Rainshower F-Series 10" 254 x 254

Consisting of:

head shower Rainshower F-Series 254 (27 285 000)

1 spray pattern:

Rain

Shower arm Rainshower 275 mm (27 488 000)

GROHE EcoJoy 9.5 l/min flow limiter

GROHE DreamSpray perfect spray pattern

GROHE StarLight chrome finish

SpeedClean anti-limescale system

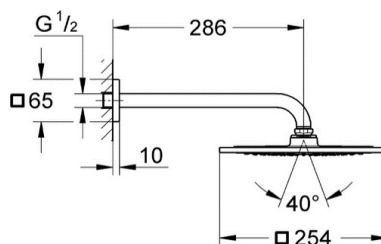

Note:

* All information of the above is for the reference only. No prior notice is made if any changes.

3 Key advantageous comparisons with another brand

1) Only 1 wall plate needed = Half expenditures + Smarter design



2) Integrated Volume Control



3) Slim Design, only 40mm overall projection for more space under the shower + smarter design

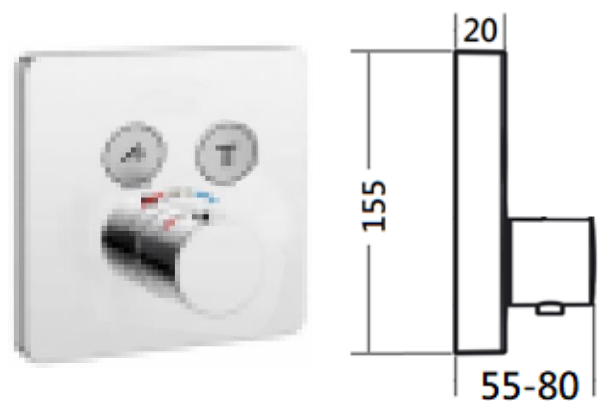
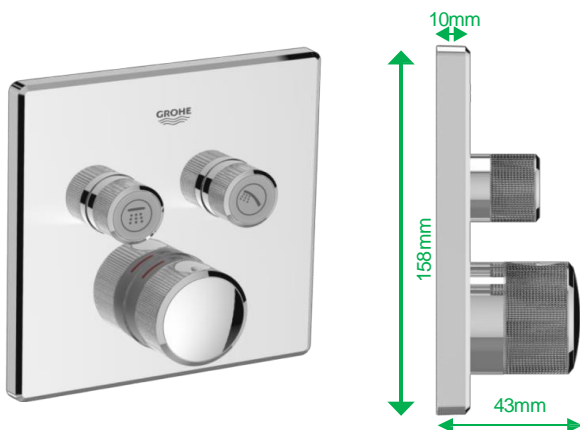

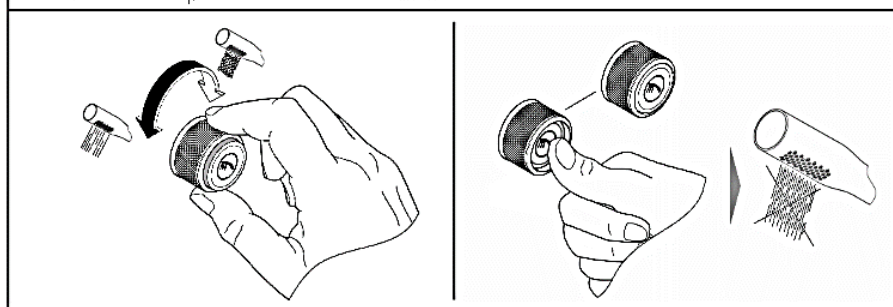
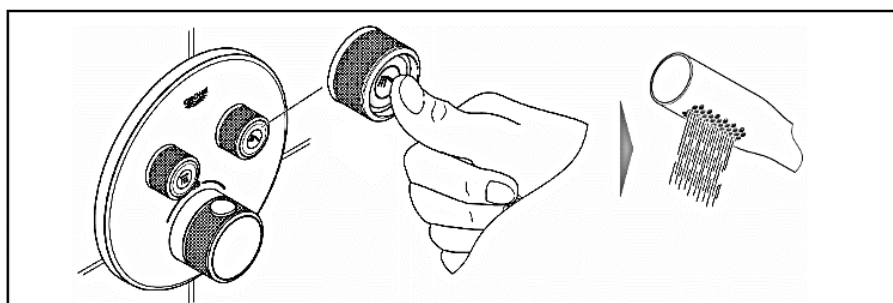
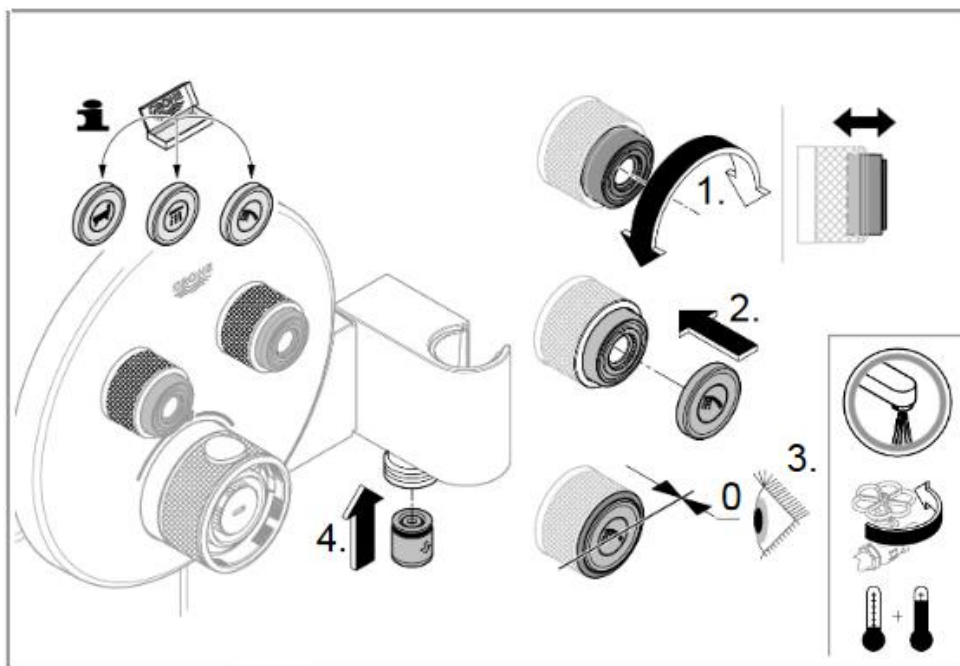
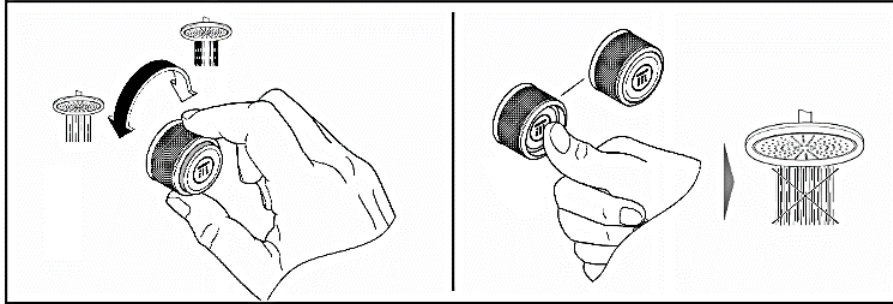
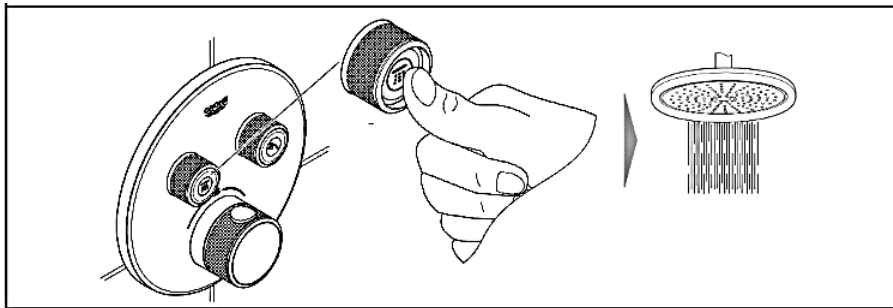



水務署
Water Supply



總部 Headquarters

香港灣仔告士打道 48 樓

48/F, Immigration Tower, 7 Gloucester Road, Wan Chai, Hong Kong

本署檔號 : (4) in WSD 3321/18 Pt.1 T/J(241)
Our ref.
來函檔號 :
Your ref.

電話 :
Tel.
傳真 : 2824 0578
Fax.

30 July 2018

Approval of "GROHE" Thermostatic Mixing Valves (General Acceptance No. C20180461)

Your letters ref. WRC/1651 dated 21 February 2018 and ref. C-WSD/0374 dated 16 April 2018 refer.

Having considered the test report ref. J21968-3r1 issued on 9 April 2018 by Nutek Systems (HK) Ltd., this Authority accepts that the fittings described below comply with, and their use when correctly installed does not contravene, the Waterworks Ordinance and Regulations.

Name of Manufacturer: Grohe AG
Country of Origin: Germany
Brand: Grohe
Details of Fitting: 1/2" Concealed thermostatic mixing valve
Model: 35600000 + 29120000
35600000 + 29125000
Body Markings: 
Expiry Date: 23 October 2022



This Authority hereby permits the use of the above fittings in fresh water plumbing systems subject to full adherence to Waterworks installation requirements. In particular, you are required to draw your customers' attention to the following requirement-

"The cold water supply to the fittings shall be drawn from the same source that supplies the hot water apparatus so as to provide a balanced pressure and to obviate the risk of scalding in the event of a restriction or failure in the water supply." AND

"The shower head or handspray should not be placed in submerged conditions and should be securely fixed to the original position after use."

A condition of this acceptance is that the fittings to be installed shall be replicas of the samples as certified by the testing agent mentioned above and without modifications. This acceptance may be withdrawn at any time if the standard of the fittings installed fails to meet that of the approved samples or if the fittings are found to be unsuitable for use in fresh water plumbing systems.

This acceptance is only applicable to the main body of the fittings, unless other specified.

For the use of the fittings in any project, the General Acceptance Number of this letter must be quoted as a means of identification of acceptance of the fittings by this Authority.

Should you have any enquiries, please contact our Engineer Mr. Terry KUNG at tel. no. 3583 4086.

Yours faithfully,



(CHAN Chung-kun)

for Director of Water Supplies

Encl.

c.c. WSD 3321/1/82] - without catalogue
 ME/MC] - with soft copy only



自願參與用水效益標籤計劃 - 沐浴花灑
Voluntary Water Efficiency Labelling Scheme - Showers for Bathing



茲證明
This is to certify that

將下列花灑在本計劃內註冊：
has registered the following shower under this scheme:

牌子 / Brand	:	GROHE
型號 / Model	:	27699000
原產地 / Country or Region Origin	:	Germany

在用水效益標籤上展示的標誌 <i>Symbolic Presentation on the Water Efficiency Label</i>	:		滴水點 <i>Water droplet(s)</i>
用水效益級別 <i>Water Efficiency Grade</i>	:	1	
耗水量 <i>Water Consumption</i>	:	9	公升/分鐘 <i>litres/minute</i>

簽發日期:
Date of Issue: 18 January 2017



水務署
Water Supplies Department



水務署署長(周世威代行)
for Director of Water Supplies



自願參與用水效益標籤計劃 - 沐浴花灑
Voluntary Water Efficiency Labelling Scheme - Showers for Bathing



茲證明

This is to certify that

將下列花灑在本計劃內註冊：
has registered the following shower under this scheme:

牌子 / Brand	:	GROHE
型號 / Model	:	27285000
原產地 / Country or Region Origin	:	Germany

在用水效益標籤上展示的標誌

Symbolic Presentation on the Water Efficiency Label

:



滴水點 *Water droplet(s)*

用水效益級別

Water Efficiency Grade

:

2

耗水量

Water Consumption

:

9.7 公升/分鐘 *litres/minute*

簽發日期:

Date of Issue:

12 September 2017



水務署

Water Supplies Department



水務署署長(周世威代行)
for Director of Water Supplies

SMARTCONTROL THERMOSTAT RANGE AT A GLANCE

CUBE



29 123 000
Grotherm SmartControl,
single



29 124 000
Grotherm SmartControl,
double



29 125 000
Grotherm SmartControl,
double, integrated
handshower union



29 126 000
Grotherm SmartControl,
triple



29 127 000
Grotherm SmartControl,
triple valve

CUBE ACRYLIC GLASS



29 153 LSO
Grotherm SmartControl,
single



29 156 LSO
Grotherm SmartControl,
double



29 157 LSO
Grotherm SmartControl,
triple



29 158 LSO
Grotherm SmartControl,
triple valve

ROUND ACRYLIC GLASS

ROUND



29 118 000
Grotherm SmartControl,
single



29 119 000
Grotherm SmartControl,
double



29 120 000
Grotherm SmartControl,
double, integrated
handshower union



29 121 000
Grotherm SmartControl,
triple



29 122 000
Grotherm SmartControl,
triple valve



29 150 LSO
Grotherm SmartControl,
single



29 151 LSO
Grotherm SmartControl,
double



29 904 LSO
Grotherm SmartControl,
triple



29 152 LSO
Grotherm SmartControl,
triple valve

CONFIGURATIONS

SINGLE (THM + MIXER)



DOUBLE (THM + MIXER)



TRIPLE (THM + MIXER)

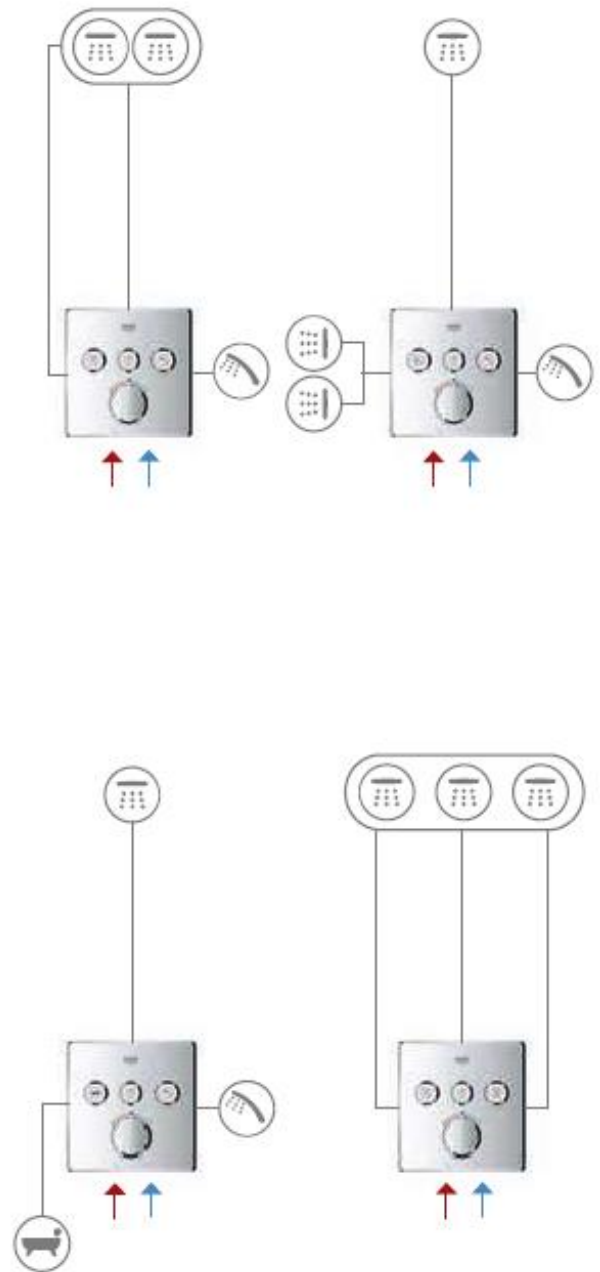

CONFIGURATIONS

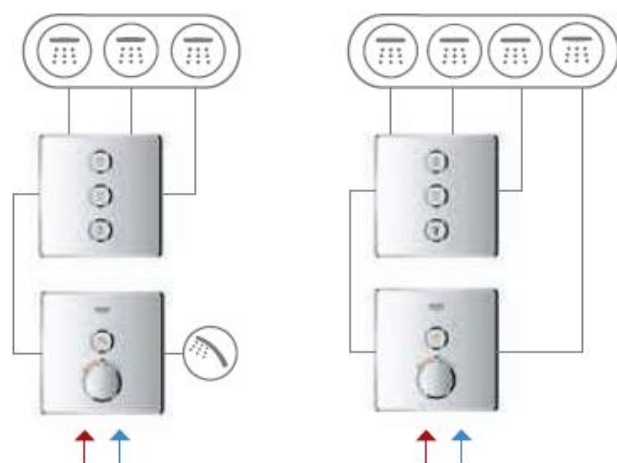
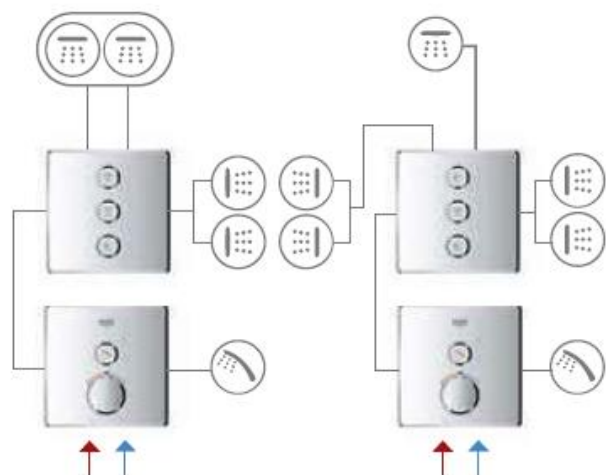

COMBINATION (THM)

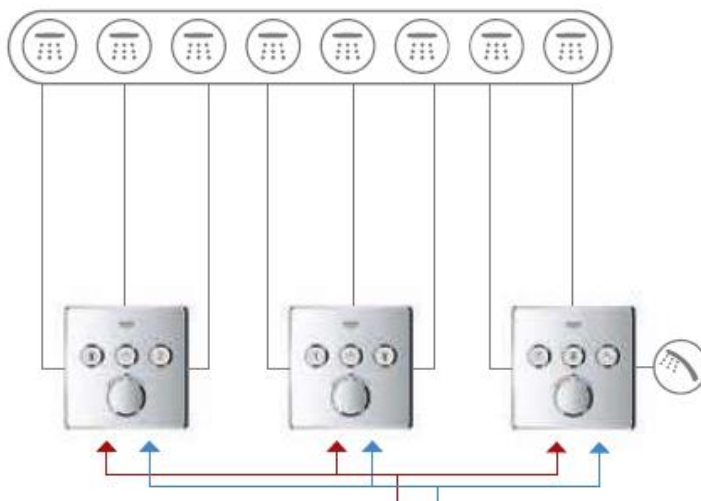

COMBINATION WITH AQUASYMPHONY



TEMPERATURE ZONE 1

- 1. WATERFALL 
- 2. RAIN 
- 3. BOKOMA 

TEMPERATURE ZONE 2

- 1. PURE 
- 2. RAIN 
- 3. WATERFALL 

TEMPERATURE ZONE 3

- 1. DRIZZLE 
- 2. AQUA CURTAIN 
- 3. HANDSHOWER 

ACCESSORIES

We gave the GROHE Rapido SmartBox its name for a reason: it is full of clever innovations and able to adapt to every one of your projects. Combine it with any GROHE SmartControl Concealed trim set for a doubly smart solution. Find out more about the many clever details of this rough-in and how to combine it with the range of add-ons.

ROUGH-IN SHIPMENT

build-in box for fixing,
sealing and noise isolation

flexible retaining ring
for optional backside
installation

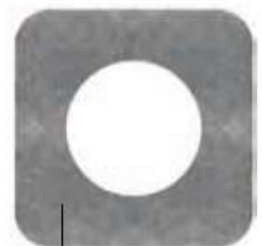

sealfleece

solid brass ring with
1/2" connections to
water supply

plug (2 pcs), to block
inlets during rough
installation

flushing plug to flush
hot and cold water
supply and to flush
the outlets



TRIM-SET SHIPMENT

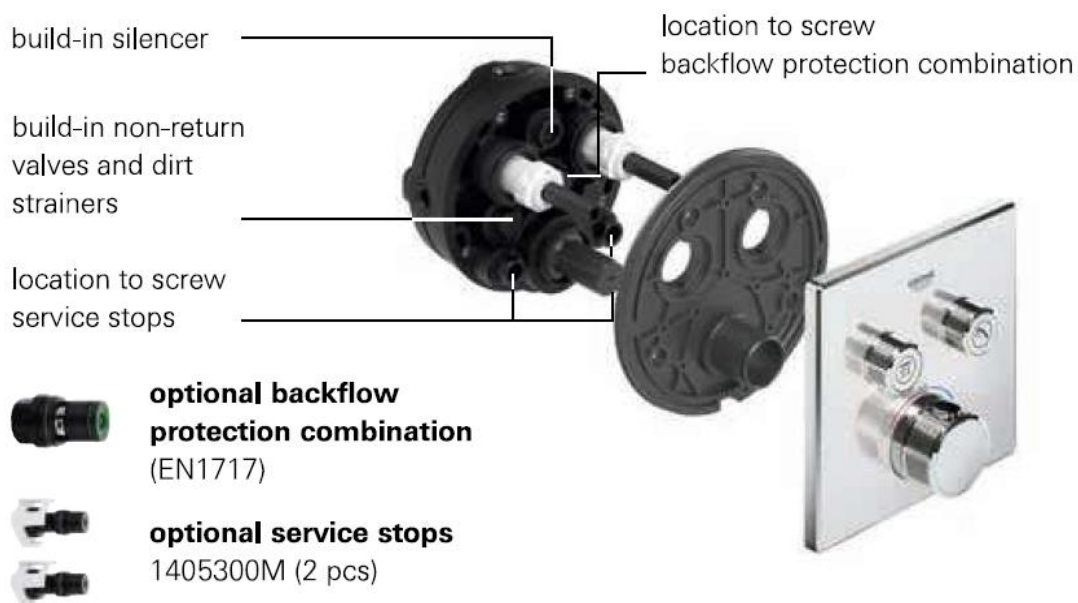
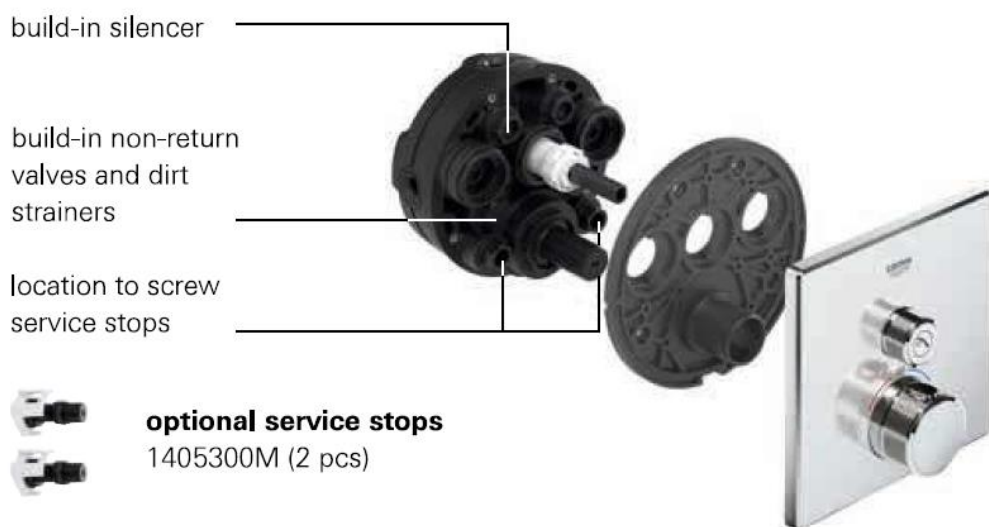

THE ROUGH-IN: MORE ADVANTAGES – NO HASSLE



THE MORE YOU KNOW, THE MORE YOU'LL LOVE IT.

The GROHE Rapido SmartBox has a multitude of well thought through features. If you take a little time to become acquainted with them, you'll quickly realise how the GROHE Rapido SmartBox will enable you to work more efficiently and effectively,

